

6F (6th Floor-Exhibition and Posters)

5F (5th Floor)

4F (4th Floor)

3F (3rd Floor)

2F (2nd Floor)

GF (Ground Floor-Main Entry)

B1 (Basement)



AUDITORIUM

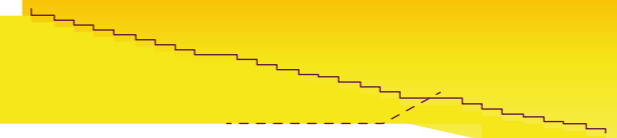
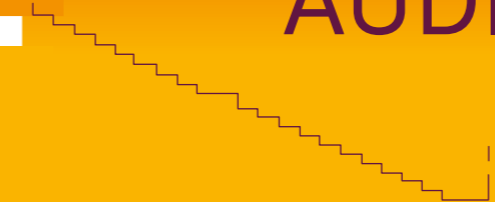

# B1 (Basement)

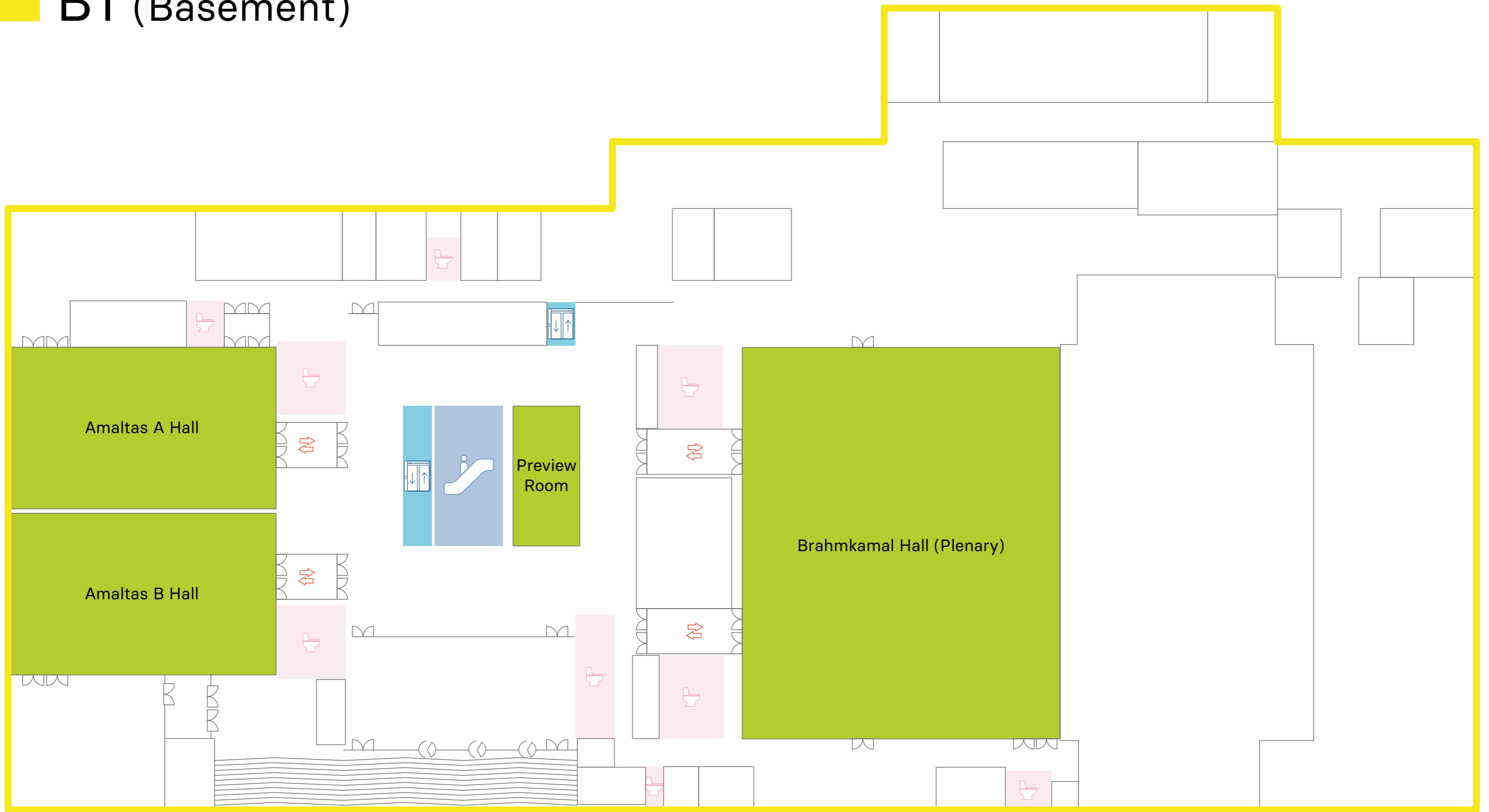

# GF (Ground Floor-Main Entry)

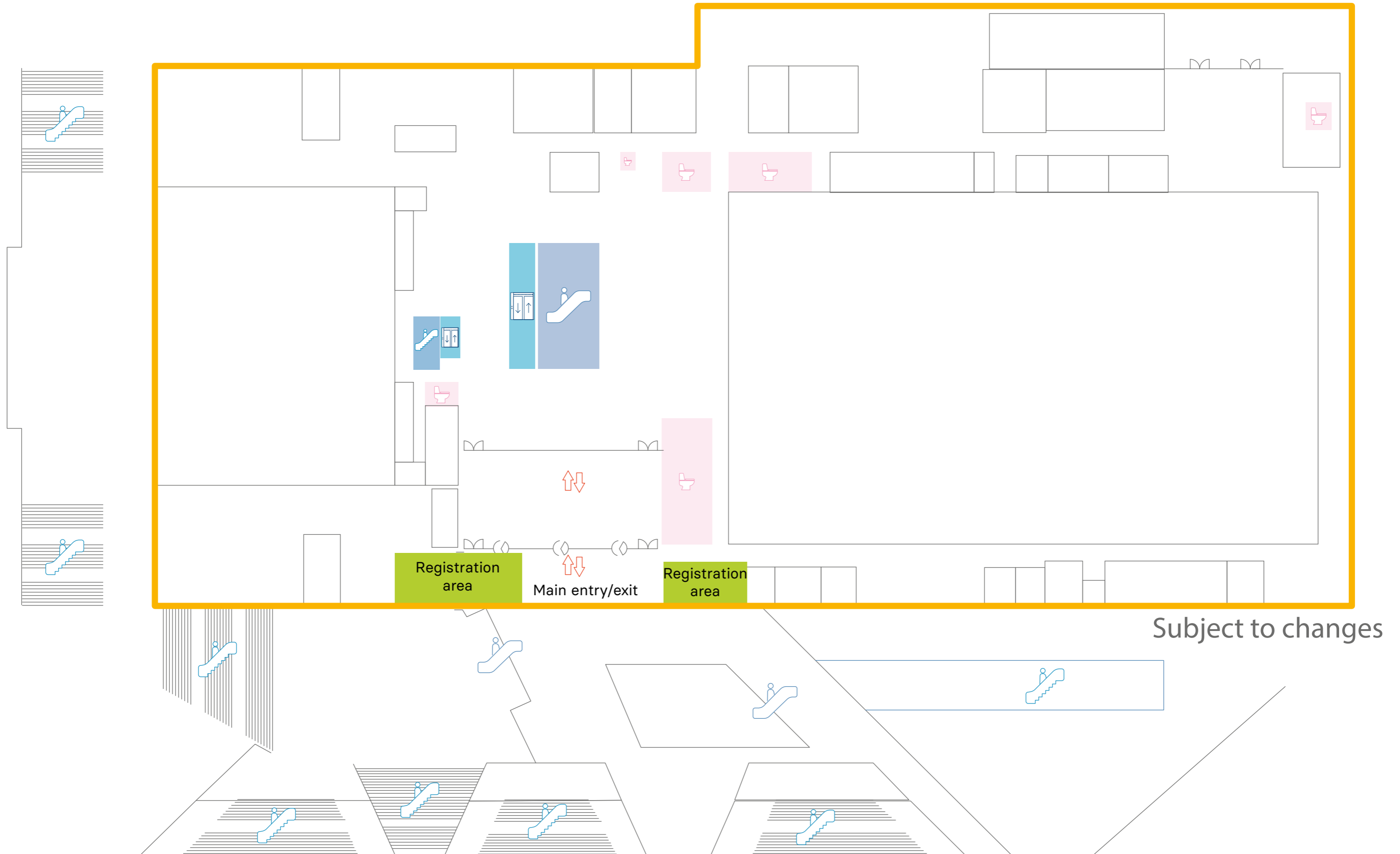

■ 2F (2nd floor)

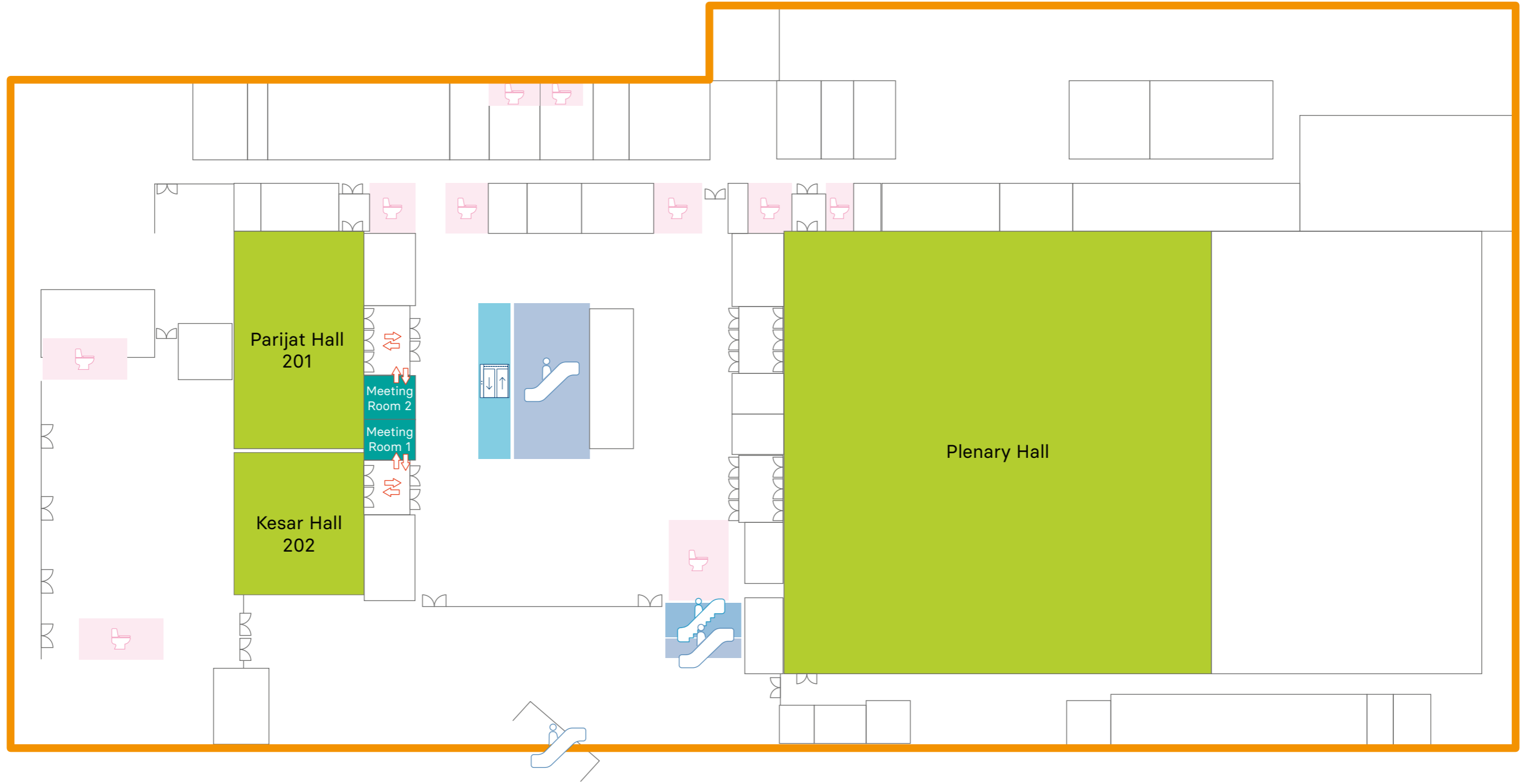

Subject to changes

■ 3F (3rd floor)



Subject to changes

■ 4F (4th floor)

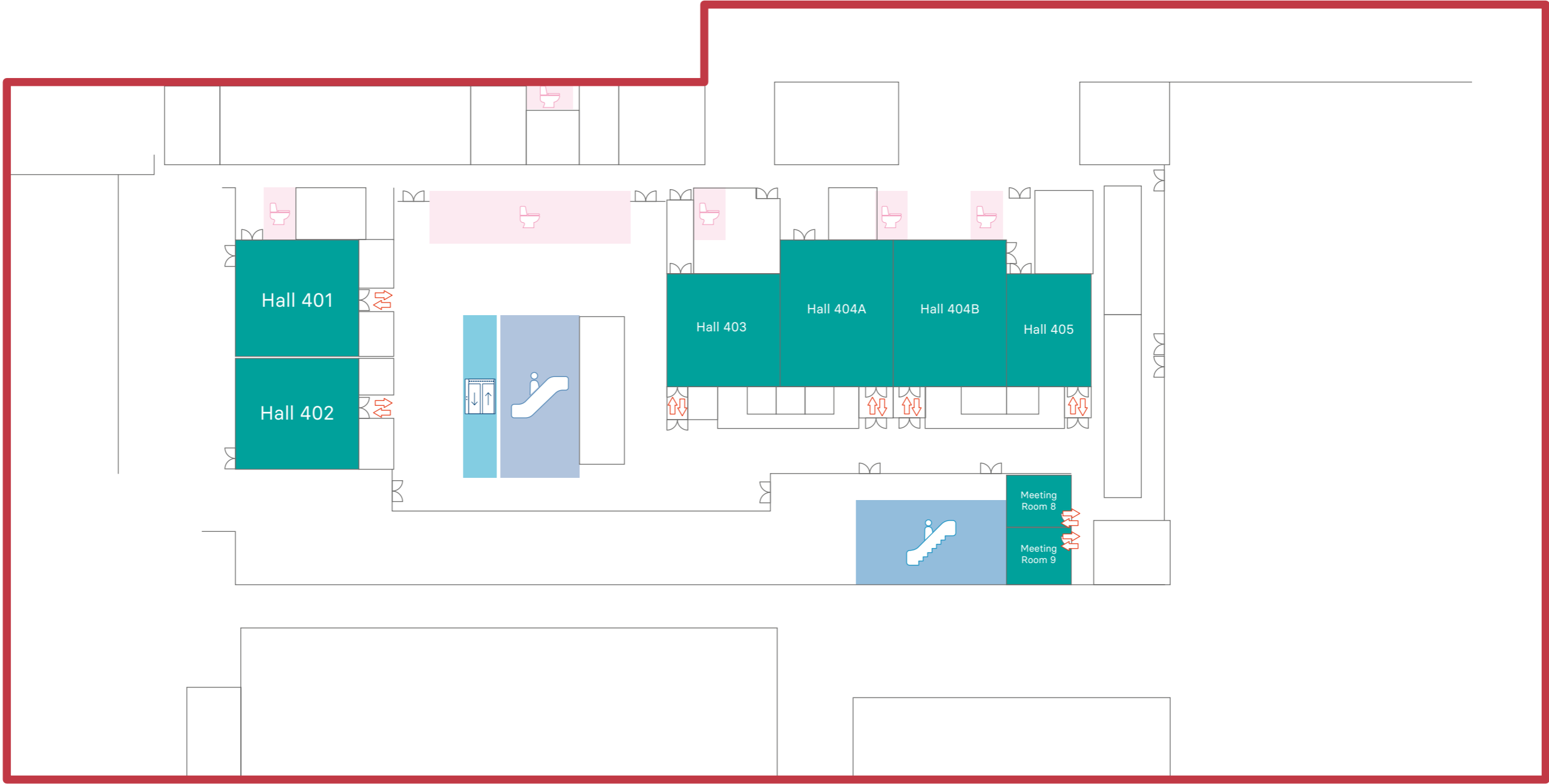

Subject to changes

■ 5F (5th floor)

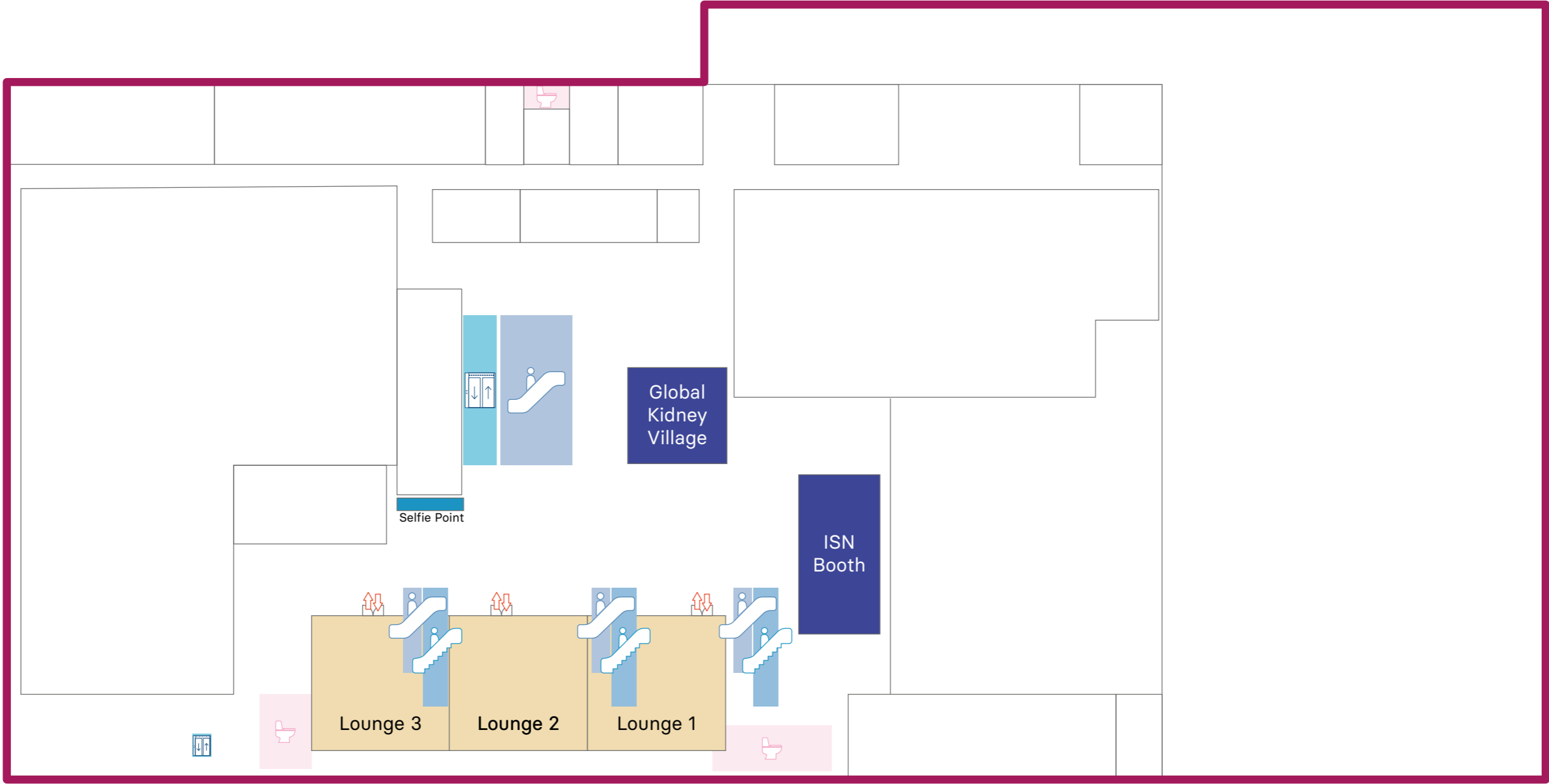

Subject to changes

# 6F (6th floor - Exhibition and Posters)

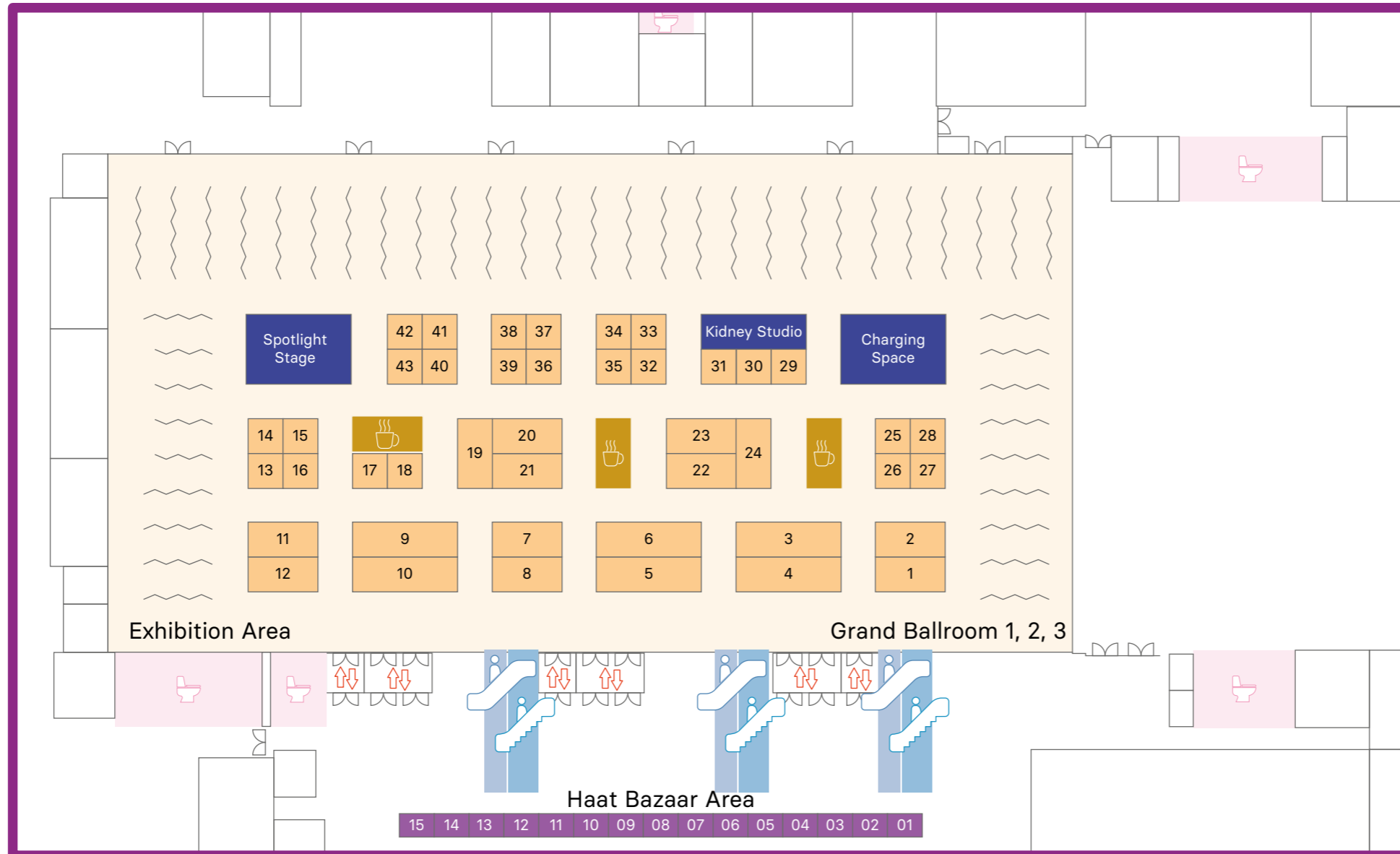

Subject to changes